



# HS-38 Single Ear Headworn Microphone

With a capsule diameter of just 3.5 mm, the HS-38 provides a super low profile combined with excellent audio output. This omnidirectional condenser headworn mic offers a lightweight single ear design with an adjustable flexible boom and hassle free earhook design that takes the guesswork and frustration out of achieving a secure and comfortable fit that accommodates different face shapes and helps eliminate pops and breath noise.

The HS-38 comes with small, medium and large interchangeable ear hooks, two screw-on replaceable audio cables, acoustically transparent windscreens and a MIPRO wireless bodypack adapter. Additional optional adapters are available for use with Shure, AudioTechnica, AKG, Sennheiser, Electro Voice, Lectrosonics, Sony and other belt packs. Optional Red Dot (RD) adapters have a built-in 15dB pad for use with MIPRO, AudioTechnica, AKG, Electro Voice and Shure belt packs.

The HS-38 is available in black, cocoa brown or beige and ships in a leatherette case. This comfortable single ear headworn mic is a perfect solution for Houses of Worship, Theaters, Lecturers, Broadcast, Corporate A/V, and other applications where premium intelligible sound and low visibility are required.

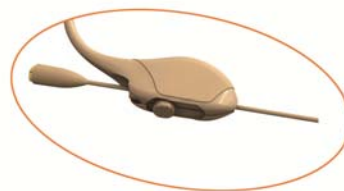

The HS-38 features an adjustable boom that easily accommodates different face shapes and helps eliminate pops and breath noise.

The HS-38 includes three interchangeable ear hooks that take the frustration out of getting a secure and comfortable fit on either ear every time.

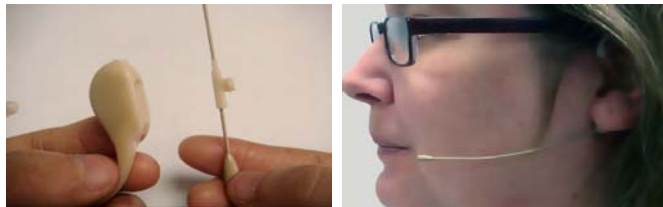

## HS-38 Specifications:

Element	Back electret condenser, 3.5mm diameter
Polar Pattern	Omni-directional
Frequency Response	20Hz-20KHz
Sensitivity	-45±3dB 1V/Pa @ 1KHz
Output Impedance	2000 Ohms±30%
SPL max	140dB (155dB with optional Red Dot adapter)
Operating Voltage	0.8V-5V D.C
Cable	Kevlar coated; 1.2m (47.25")
Capsule Diameter	3.5mm
Color	Black, Cocoa Brown or Beige
Wireless Body Pack Adapter	Included adapter: T5 Mipro Optional adapters: T1 & T1RD AudioTechnica, T2 & T2RD AKG, T3 Sennheiser, T4 & T4RD Shure, T5RD Mipro, T8 and T8RD Electro Voice, T9 Sony, T14 Lemo and T15 Lectrosonics
XLR Adapter	Optional adapter : MJ-53 for wired use
Accessories	Spare audio cable and windscreens
Weight	13g (0.46 ounces)

## Avlex HS-38 Headworn Microphone Fitting and Handling Guide

The boom of the Avlex HS-38 microphone is made of a lightweight, flexible soft metal. Please avoid bending the boom at a sharp angle. The soft metal of the HS-38 bends easily but care should be taken when making adjustments to avoid damaging the microphone. Use a round object or the edge of your finger as a guide to avoid kinking the boom. Repeated bending in the same location will eventually cause a break in the boom or internal wires. Do not attempt to bend the boom near the capsule or next to the connector.

The HS-38 includes three interchangeable ear hooks that take the frustration out of getting a secure and comfortable fit on either ear every time. Changing the ear hook is a simple operation. First try on the mic fitting the connector behind your ear lobe as shown below in figure 5. If it is too tight or too loose, changing the ear hook is a simple operation.

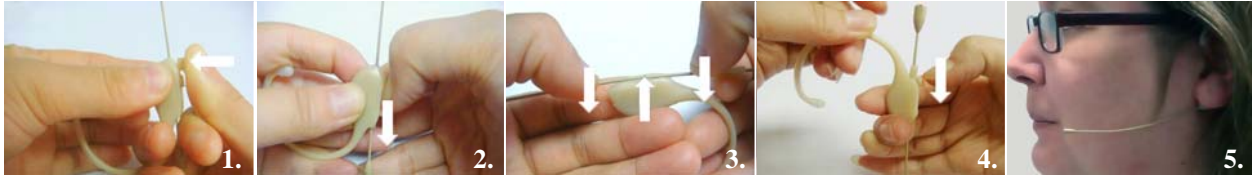

**Changing Ear Hooks:** (if the desired ear hook is already in place, please skip to Adjusting Boom Length and Placement)

1. Insert the supplied removal tool into the slot above the boom locking button and pull down firmly to disengage the boom and slider from the slot.
2. Carefully remove the boom from the ear hook.
3. Select the ear hook which provides the best fit for your ear and carefully press the boom back into the slot on the earpiece.
4. Push the slider firmly back into the earpiece slot.

### Adjusting Boom Length and Placement:

The HS-38 features an adjustable boom that easily accommodates different face shapes and helps eliminate pops and breath noise. Adjusting the length of the boom arm is also a simple operation.



1. Push the locking button back to loosen the slider.
2. Rotate the boom slightly while making adjustments to the desired length to avoid undue stress to the boom arm. The optimum position is when the capsule is located just behind the edge of your mouth.
3. Push the locking button back to lock the slider in place.
4. Gently curve the boom to the right for left ear use or to the left for right ear use. Use your thumb and forefinger to shape the boom carefully to allow about 1/2 inch between your cheek and the microphone.
5. The optimum position is when the capsule is located just behind the edge of your mouth when you smile and about a half inch from the side of your face. Do not position the capsule directly in front of the mouth. This will result in "pops" and breathing noise. The pickup pattern will allow for the mic to function well over a large area.

To view a short video on these procedures, please visit the Avlex microphone section of our web site at [www.avlex.com](http://www.avlex.com).

The HS microphones use a replaceable, Kevlar covered cord. These cords are as light as possible in order to keep them comfortable and provide low visibility. Use caution when wearing and removing the mic and bodypack to keep the cord safe. Do not wrap excess cord around the bodypack. This will stress the cord and adapter and will result in the mini coaxial connector being broken.

Thank you for choosing the Avlex HS-38 headworn microphone. We're confident you'll find it to be an excellent product that is lightweight and comfortable which will produce a clear and natural sound for years to come.

#### LIMITED ONE YEAR WARRANTY

This Limited Warranty is extended by Avlex Corporation to the owner of any Avlex HS or HSP series microphone purchased in the United States of America, the District of Columbia, Puerto Rico, or the US Virgin Islands. Avlex Corporation will repair or replace, at its sole option, any covered Avlex product that fails due to a defect in material or workmanship within one year following the date of the initial user purchase.

Cables and windscreens are excluded from coverage under this warranty. Product failure caused by misuse, abuse, neglect, accident, improper wiring or improper installation is not covered by this warranty.

This warranty does not cover any loss of time or income that may be caused by the failure of a warranted product. Some states do not allow the exclusion or limitation of incidental or consequential damages, so the above exclusion may not apply to you.

To obtain performance under this warranty, return the warranted product with proof of the purchase date to the place of purchase, or contact Avlex Corporation Customer Support at 877-447-9216. A Customer Support Representative will go through the standard troubleshooting procedures in an effort to resolve the problem. If it is necessary to return the product you will be given a return authorization (RA) number and shipping instructions. Please be certain to write this information down. The product being returned along with the RA number, your contact information, and proof of purchase must be securely packed in an adequate (corrugated) shipping carton. The RA number must be written on the outside of the shipping carton (on the shipping label). You will be responsible for freight charges to Avlex and the product will be returned via UPS Ground with the shipping charges prepaid. Expedited shipping is available at an additional cost.

This warranty gives you specific legal rights, and you may also have other rights which vary from state to state.